

Attachments: Summary of Operation

Copy emailed to Fred & Silvia Curl in Florida

Summary of Operations

SML Garbage Collection, Inc.

This business was established in 1994.

SML collects commercial accounts' trash\ garbage and dumps at Franklin County Landfill, Mon-Sat.

Front load equipment runs daily from early A.M. and return 5-6- P.M.

Roll- Off equipment runs as needed upon request from customers.

Empty, (new and used) containers are stored on this lot awaiting placement (and \ or refurbished) with customers. The number of units stored on site fluctuates with number of customers.



Prepared By:

SML Garbage Collection

- > Special use permit is effective immediately after action by the Board of Supervisors
- > Special use permits expire in 18 months if there is no commencement of the use or related activity

FRANKLIN COUNTY
PETITION/APPLICATION FOR SPECIAL USE PERMIT
 (Type or Print)

I/We, Jerry B Shaver, as Owner(s), Contract Purchasers, or Owner's Authorized Agent of the property described below, hereby apply to the Franklin County Board of Supervisors for a special use permit on the property as described below:

1. Petitioners Name: Jerry B. Shaver, SML Garbage Collection, Inc.

2. Property Owner's Name: Fred & Silvia Curl

Phone Number: (941) 380-3032

Address: 1261 Smithmountain F Penhook
VA Zip: 24137

3. Exact Directions to Property from Rocky Mount: _____

4. Tax Map and Parcel Number: Tax Parcel # 0540026900

5. Magisterial District: Union Hall

6. Property Information:

A. Size of Property: 1.93

B. Existing Zoning: B-2

C. Existing Land Use: Vacant

D. Is property located within any of the following overlay zoning districts:

Corridor District Westlake Overlay District Smith Mountain Lake Surface District

E. Is any land submerged under water or part of a lake? Yes No If yes, explain.

7. Proposed Special Use Permit Information:

A. Proposed Land Use: Storage of Empty Garbage/Trash Containers

B. Size of Proposed Use: All the property

C. Other Details of Proposed Use: _____

Checklist for completed items:

- Application Form
- Letter of Application
- List of Adjoining Property Owners and Addresses
- Concept Plan - *Not applicable - simple storage equipment + storage.*
- Application Fee

I certify that this application for a special use permit and the information submitted herein is correct and accurate.

Petitioner's Name (Print): Jerry B. Shaver
Signature of Petitioner: *Jerry B. Shaver*
Date: 3-31-2017
Mailing Address: P.O. Box 725
Hardy, VA 24101
Telephone: (540) 721-7654

Owner's consent, if petitioner is not property owner:

Owner's Name (Print): Fred & Sylvia (Curl)
Signature of Owner: *[Signature]*
Date: April 5, 2017

Date Received by Planning Staff: _____
Time: _____
Clerk's Initials: _____
CHECK #: _____
RECPT. #: _____
AMOUNT: _____

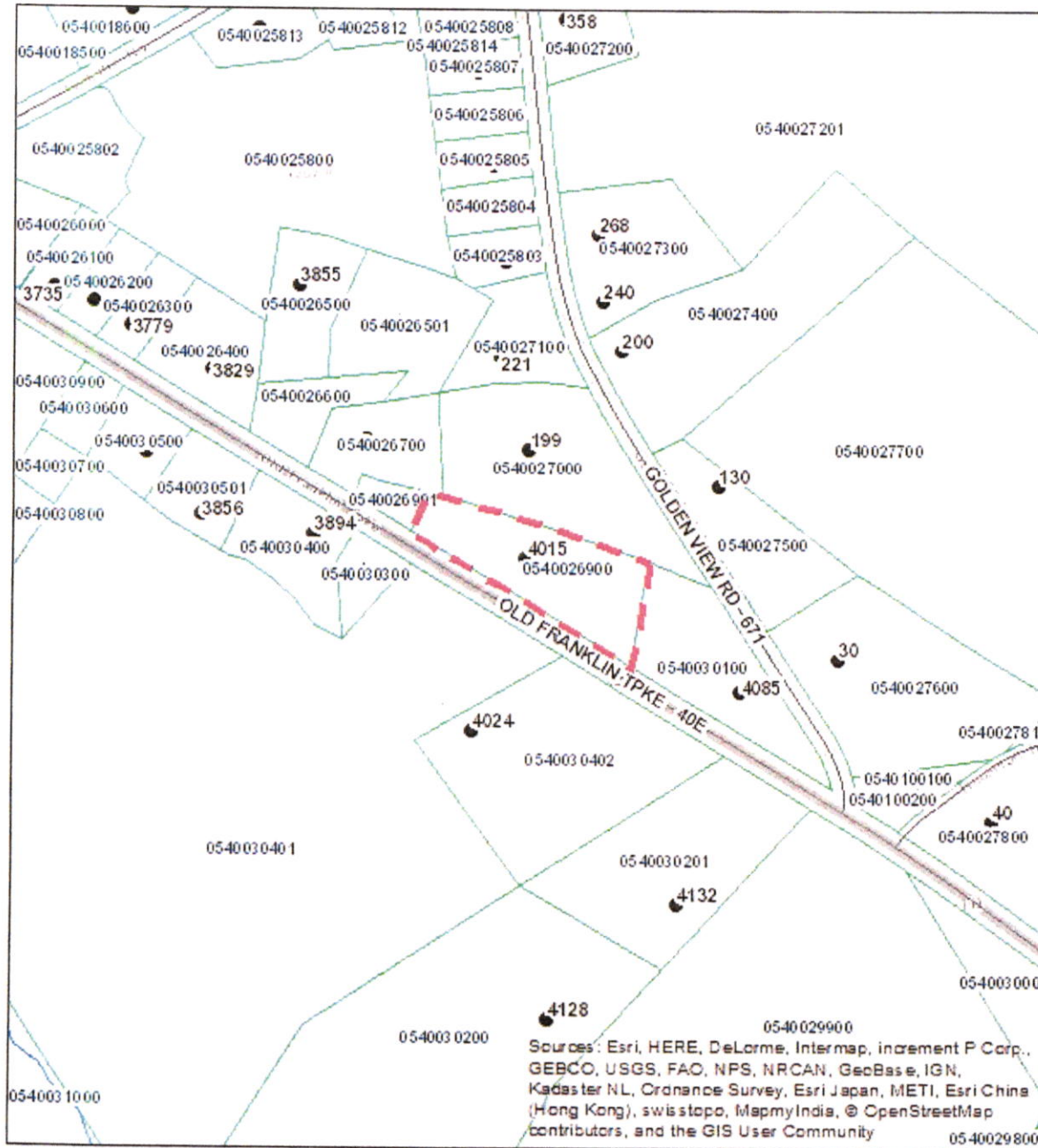

Layer: Parcels

Map: 054
Insert: 00
Lot: 269
Parcel ID: 0540026900
Extension: 00
Recno: 17957
Map: 05400
Parcel: 26900
Zoning: B2
Owner: CURL FRED D & SYLVIA
Owner Address: 1261 SMITH MOUNTAIN F
City: PENHOOK
State: VA
Zip: 24137
Description 1: RT 40 EAST
Description 2: TRACT B
Acres: 1.93
Land Value: 77200
Building Value: 1200
Sale Price: 87000
Sale Date: 09/07/2016
Deed book: 1082
Deed page: 288
Plat book: 415
Plat page: 966
Instrument type: DF
Instrument year: 2016
Instrument number: 5424
District: UH
Grantor: MEDLIN CATRINA M
Shape.STArea(): 84107.58984375
Shape.STLength(): 1382.2712882781

Attributes at point: 11101395, 3532761	
Layer: School Districts	School District: Glade Hill
Layer: Election Districts	District Name: Union Hall Supervisor: Tommy Cundiff
Layer: Precincts and Political Districts	Precinct Name: Glade Hill House District: 9 Senate District: 19
Layer: Voting Precincts	Name: Glade Hill
Layer: Franklin County Zoning	